

Item 12 Appendix 1

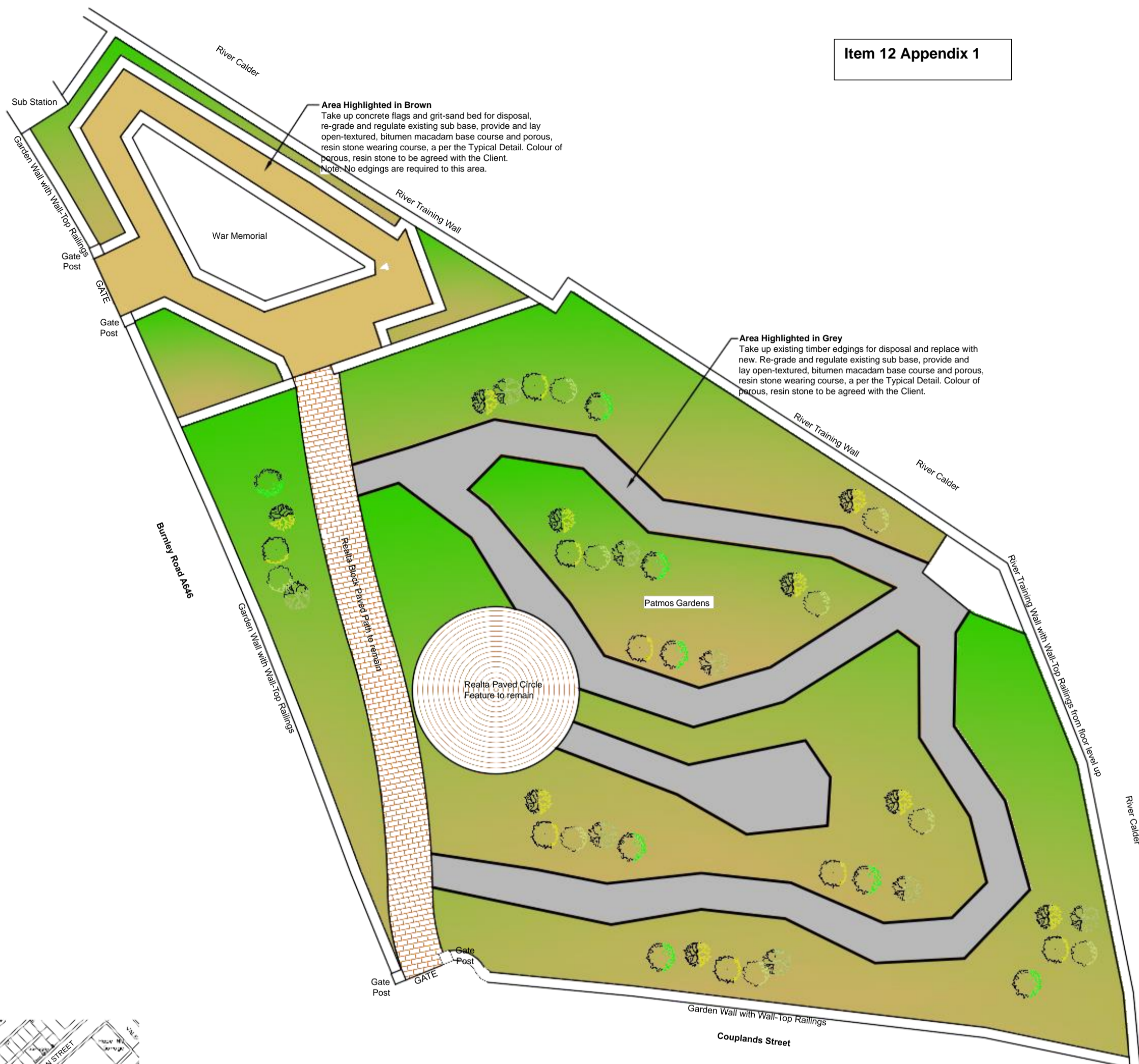

General Plan Arrangement
Scale 1/100

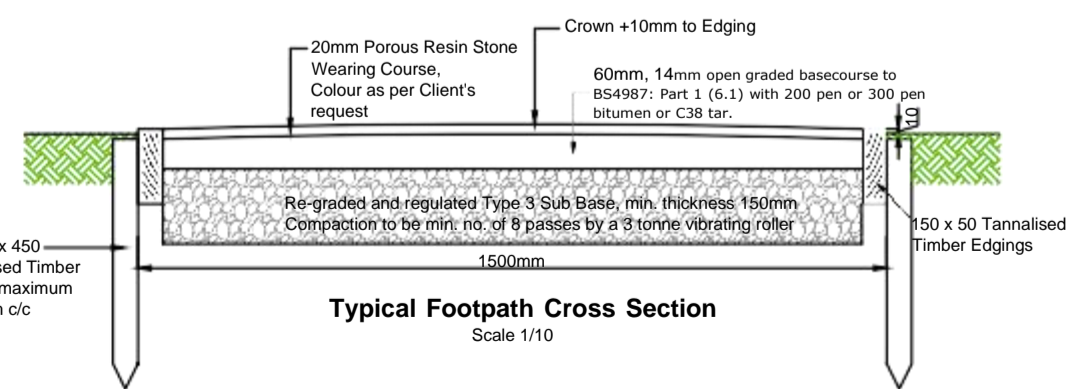

GENERAL NOTES

COMPETENT CONTRACTOR
All contractors should be qualified, experienced and competent. All work should be undertaken in accordance with current British Standards, Codes of Practice, Health and Safety Legislation, IEE Regulations, Gas Safe Regulations and Manufacturers Instructions.
Contractors are strongly advised to visit the site to clarify any issues with the Engineer before tendering for the works.

MANUFACTURERS INSTRUCTIONS
All materials, plant and equipment to be installed by an experienced, competent contractor in accordance with the manufacturers instructions.

ALTERNATIVE MATERIALS
Alternative materials and construction detail may be used providing the specification and performance, for the design life of the material, detail or unit, is at least equivalent to that specified on this drawing. Approval for the use of alternative materials, detail or unit has to be agreed with the Client, Engineer and the local Building Control Authority, where applicable.

DIMENSIONS
The Client and Contractor should satisfy themselves that the dimensions shown on this drawing are accurate. Any discrepancies or preferred alterations should be approved by the Engineer in advance so as not to prejudice the time and cost of construction.

FOUNDATIONS (Where Shown)
The required bearing capacity of the soils at founding level is 125kn/m2 original ground without any underlying issues giving cause to settlement and/or subsidence. If there is any doubt the Client is advised to appoint a site investigation specialist.

AUTHORISATIONS
The Client and Contractor should ensure that Planning Approval and Building Regulation Approval have been granted by the Local Authority before any work commences, if required.
The Client should ensure that, where appropriate, a suitable Party Wall Notice has been served to adjacent property owners under the Party wall Act 1996

CLIENT AGREEMENTS
Where a specified item or installation requires Client and/or Building Control Officer agreement the Contractor should establish, if possible, the exact requirements before pricing the works. If the requirements are not able to be agreed at the time of pricing then the Contractor should make it explicitly clear to the Client which items are excluded at the time of pricing and what effect the omission will have, if any, on the programming of the works both in time and cost.

REPRODUCTION OF THE CONTENTS OF THIS DRAWING
This copyright of this drawing and its' contents belong to the Architect/Engineer stated at the bottom of the drawing. No unauthorised reproduction, in part or whole, in any form whatsoever is permitted without the expressed permission of the Engineer.

LIST OF PRINCIPAL MATERIALS
As illustrated on the drawing

LIST OF DRAWINGS
1 of 1 General Arrangement and Specification

Contractor Details

Name of Contractor: _____
 Contractor's Representative: _____
 Contact Tel. No: _____
 Email Address: _____
 Date of Tender: _____

NOTE: No part of these works is to be sub-contracted
 The Contract Period will be 14 Days (subject to weather)

ITEM	Unit	Quantity	Rate	Amount
Insurances				
Insurance of the Works	Sum			
Insurance of Construction Plant	Sum			
Insurance against damage to persons and property (min. £5 million)	Sum			
Site Security				
Having visited the site, the Contractor is to enter a value which he/she considers is sufficient to secure the site for the duration of the works.	Sum			
Welfare				
Having visited the site, the Contractor is to enter a value which he/she considers is sufficient to provide welfare facilities for his/her employees, for the duration of the works.	Sum			
General Site Clearance				
Excavate and dispose of existing concrete paving and sand bed to the War Memorial area.	m ²	51.0		
Excavate and dispose of the existing timber edgings and stakes to the garden area.	m	325.0		
Footway Construction				
Re-grade pathways to the garden area.	m ²	140.0		
Provide and lay 150 x 50 tannalised timber edgings to line and level as directed by the Engineer.	m	325.0		
Regulate the pathways to the garden area.	tonnes	6.0		
Provide and lay 60mm, 14mm open-textured base course.	m ²	191.0		
Provide and lay 20mm porous, resin-stone wearing course	m ²	191.0		
Sum				
Allow 10% Contingencies				
Grand Total				

