

Item 8b – Resources Committee 16th Feb 2021

Email comment from [REDACTED]

There are a couple of questions in there that would be good to work out with you early in the new year if possible. One is checking a bit of a revision to spend to reflect other funding we received. And another is to get a general sense if this may be a project that the council would consider supporting some of the core costs of via repeat funding as that would really help our planning.

Project Report Makery Workshop December 2021

Summary

The project is progressing well. Physical Infrastructure is mostly in place and volunteers coming forward to take on different levels of responsibility. We have had a fantastic level of positive feedback from the users of the space and a huge amount of support from the people of the town via donations and helping to spread the word about the project.

We have secured additional funding from the National Lottery. As such, we would like to request a revisions to how we spend the £3000 granted to us to include some project work to bring a more diverse set of people into the workshop. This would replace some of the rent and insurance costs. We feel this is in the best interests of the town as it will reach more of the people.

The following areas have emerged as being key to the needs of the volunteers and members.

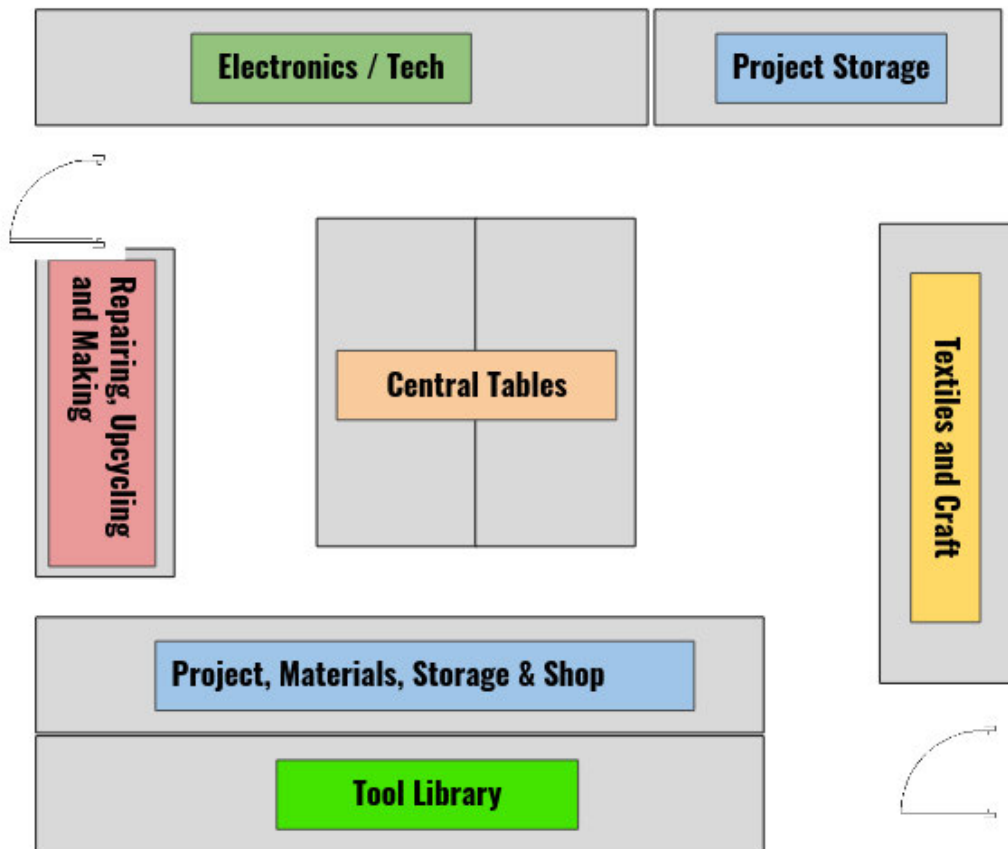

- **Textiles and craft** - makery-textiles-craft@googlegroups.com - This involves sewing machines, an archive of textile materials and basic crafting materials. **Currently seeing a co-ordinator.**
- **Electronics / Tech** - makery-electrotech@googlegroups.com - a set of laptops and screens, electronics equipment, 3D printer, computer repair tools - **Co-ordinator** [REDACTED]
- **Repairing, Upcycling and Making** - makery-general-repair@googlegroups.com - a workbench with vices and clamps, hand tools, and some power tools, and (etc) wood material store - **Currently seeing a co-ordinator.**
- **Bikes area** - makery-bikes@googlegroups.com - bike tools and stand, and some limited spare parts - **Co-ordinators** [REDACTED]
- **Tools Library** - [REDACTED] - power tools, some audio equipment, ladders etc. **Co-ordinator** [REDACTED]
- **Projects, Materials, Spares Areas and Free Shop** - no group yet - a set of cupboards and trays with spare parts for repairs, donated electronic equipment for repair, and free shop **Currently seeing a co-ordinator.**
- **Outreach, Organising Communication** - makery-communication@googlegroups.com - updating website and publicity, helping members know about decision making and encouraging projects - **Currently seeing a co-ordinator.** [REDACTED] **currently helping)**

Breakdown of Activities

A weekly timetable and a calendar of one off events is available on our website here <https://todmordenmakery.org.uk/events-calendar/>

	Monday	Tuesday	Wednesday	Thursday	Friday	Saturday
9:00 AM						
10:00 AM			Quiet Session			Open Session / Drop In
11:00 AM			Quiet Session			Bikes Repair Drop In
12:00 PM						Members (induction needed)
1:00 PM						
2:00 PM						
3:00 PM						
4:00 PM						
5:00 PM						
6:00 PM						
7:00 PM						
8:00 PM						

Drop-in Sessions: The drop in sessions were the core of the proposed activity of the workshop. We started with three drop ins per week and have built up to four. Mondays are a bike drop in. Wednesday evening, Friday daytime and Saturday morning are general repairing and making sessions.

Workshops / Short Courses: There have been a number of activities run by members who have come forward to offer these courses free of charge.

<https://todmordenmakery.org.uk/category/workshops/>

In the future we may look to pay workshop leaders to deliver sessions that our volunteers don't have the skills to run or to do outreach to involve groups who are not currently engaging with the space.

Members Time: The workshop is also open for members to continue working on repairing or making projects outside of the drop in times. We have found appropriate insurance for "Maker Spaces" to allow this to be possible.

Tool Library: While the funding for the actual tools is separate from the Makery Workshop, it is subsidised by free rent of a lockable cupboard. As such the Town Council grant goes to support this part of the project as well.

Family Sessions: Some family sessions have taken place this year. Some as part of a funded project with paid facilitators and open to all. And some additional sessions, unfunded, run by parents. We feel more facilitated - open to all sessions - may work to bring a more diverse set of people into the space.

Report on Organisational / Financial Issues

How we organise: The process of involving volunteers in decision making is taking place with volunteer meetings. We have run two volunteer meetings to make sure that the project is directed by volunteers. The following online documents have come out of these meetings.

[Guidance for volunteers for Makery Drop in Sessions](#) - based on questions from volunteers from our first volunteer meeting

- [Feedback page](#) - for volunteers to input ideas / feedback / problems anonymously if they want to - also to suggest projects for the Makery to take on
- [Feeling Wonky](#) - a poster about signposting around mental health issues for members and for volunteers
- [Health and Safety docs](#) - volunteers / members agree when to these when joining
- [Safeguarding Policy](#) - volunteers / members agree when to these when joining

At the moment key financial decisions are made by the directors of the company running the project

A current aim is to solidify a group of handful of core volunteers to undertake financial decisions, outreach and other decision making involving the use of the workshop. The process is underway and detailed in the [Guidance for volunteers](#) document.

Other Funding and revision to spending: Other funding was secured from the National Lottery (9,620); this has been mostly allocated to purchases of specialist equipment and to covering rent costs. We would like to suggest a slight revision to how we spend the £3000 granted to us to include some outreach project work to bring a more diverse set of people into the workshop. To check this we will send a separate email.

Future Funding and Financial Overview: One aim of the project has been to keep overheads and ongoing costs low. In this way the project can be a sustainable part of the town infrastructure, run by volunteers with strong participation from its members. We are aiming for a turnover of around £5 000 next year once our core equipment is in place. Low costs are important to keep the project stress free for volunteers co-ordinating it.

This has been achieved in part with the support of Tod College allowing us to pay half rent for 3.5 days per week while still keeping equipment in the space full time. We have also started a membership scheme which is free for the first year. We will introduce a pay-what-you-can scheme for next year. We also have a pay-what-you-feel shop to bring in donations and are working on an interactive donations box with lights and sound to encourage donations.

Spending Overview and Significant Purchases:

There are some significant purchases and a lot of small outgoings which are needed to set up a working workshop.

- Industrial Sewing Machine
- Soldering Station
- Wood for Central Tables
- Bench Power Supply
- Bike Repair Parts
- 3 Laptops and equipment.

Snap Shot of Finances: This is a very rough snapshot of finances as of December 2021. There are quite a few part spends or allocated costs that are not included here.

Makery Funding in	
Town Council	3000
Lottery	9630
Total	12630
Outgoings By Funding Source	
Town Council Spending	-1080.27
Lottery Spending	-2325.94
By Makery Project Areas	
Mk General Repair	-609.85
Mk Textiles	-22.73
Mk Electro Tech	-694.4
Mk Bikes	-150.01
Mk Admin and General	-421.96
Mk outreach and volunteer costs	-196.86
Mk Rent	-1239
Mk Start Up	-131.15
Total	3465.96

Other Support: The amount of support and donations from members of the general public and the college has been very generous. The following have been donated.

- Sewing machines x 5
- Scroll Saw
- Band Saw
- Large Flat Screen TV x 2
- Router
- Extensive Wood Materials to construct workbenches